

## SINGLE DOOR, SURFACE MOUNT (PUSH) OFFSET PIVOT/BUTT HINGE

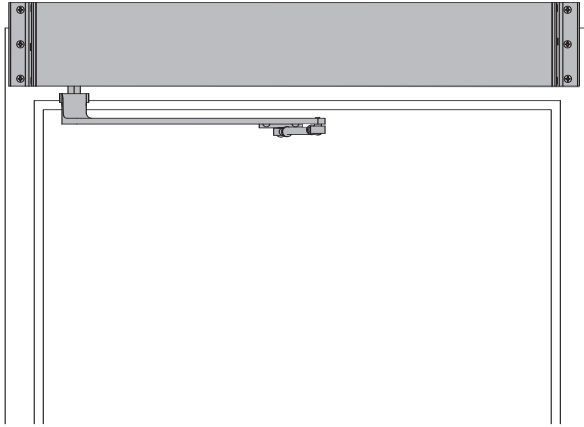

*The 9540 SENIOR SWING by LCN is an ADA door operator that is a two-in-one swing door operator. SENIOR SWING operators when activated, opens doors automatically for wheelchair access, yet allows for manual operation for regular pedestrian traffic.*

- ▶ **Push 'N Go permits non-switch activation**
- ▶ **Power Boost provides additional latching force**
- ▶ **Electromechanical unit with microprocessor control**
- ▶ **Digital keypad for easy setup**
- ▶ **Tested internally to over 10,000,000 cycles**
- ▶ **Meets International Building Code requirements and ANSI A156.19**
- ▶ **UL approved for fire doors**

- ▶ 9540 series operator is shipped with motor gearbox, control box, regular arm, header, and mounting hardware. Actuators available separately, see pages 199-215.
- ▶ Single door, surface mounted.
- ▶ Meets ADA requirements (power mode only).
- ▶ Handed product.
- ▶ 36" header length is standard. Specify length 33" to 49" max.
- ▶ Double door header available up to 98", specify other length 49" to 98" max. Consult factory regarding this option.
- ▶ Adjustable hold open period of 1 to 32 seconds in automatic or manual mode.

*9540 Series is fully compliant with UL 325 & UL 1998 and meets the provisions of ANSI A156.19. The 9540 Series is UL listed for fire-rated applications. The 9540 Series also meets the provisions of the Americans with Disabilities Act.*

MOUNTING						HANDING			FINISH	COVER		ARM FUNCTION		
<input checked="" type="checkbox"/>	<input type="checkbox"/>	<input type="checkbox"/>	<input type="checkbox"/>	<input type="checkbox"/>	<input type="checkbox"/>	<input checked="" type="checkbox"/>	<input type="checkbox"/>	<input type="checkbox"/>	<input type="checkbox"/>	<input type="checkbox"/>	<input type="checkbox"/>	<input type="checkbox"/>	<input type="checkbox"/>	<input type="checkbox"/>
SURFACE MOUNT SINGLE DOOR						STANDARD ANODIZED			METAL	STANDARD (SINGLE)		REGULAR (SINGLE)		
SURFACE MOUNT SIMULTANEOUS PAIR						CUSTOM ANODIZED				DOUBLE (DOUBLE)		OFFSET PIVOT (PUSH/PULL)		
SURFACE MOUNT INDEPENDENT PAIR						CUSTOM PAINT				REGULAR (DOUBLE)		CENTER PIVOT ARM		
CONCEALED SINGLE DOOR						NON-HANDED				DOUBLE (DOUBLE)		OFFSET PIVOT ARM		
CONCEALED SIMULTANEOUS PAIR						HANDLED				REGULAR (DOUBLE)		CENTER PIVOT ARM		
CONCEALED INDEPENDENT PAIR						NON-HANDED				DOUBLE (DOUBLE)		OFFSET PIVOT ARM		

AVAILABLE  
 NOT AVAILABLE

# LCN 9540 SERIES

## MOUNTING DETAILS

### TOP JAMB SINGLE DOOR (OFFSET PIVOT/BUTT HINGE, CENTER PIVOT, PUSH) MOUNTI

Consult factory for all balance door installations.

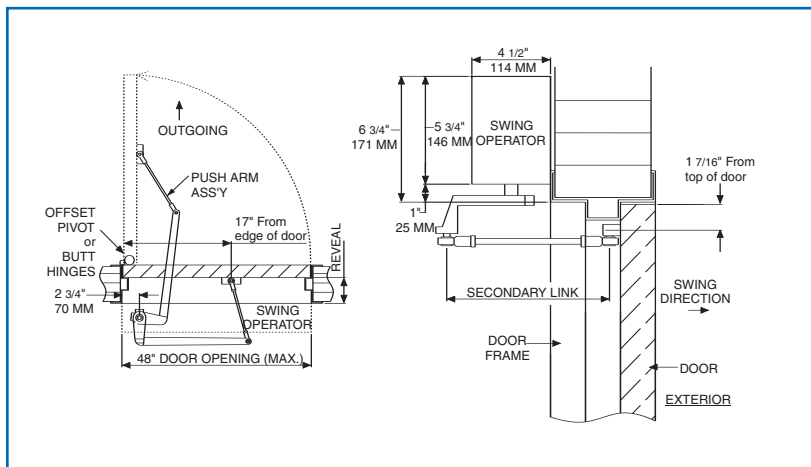

### HOLLOW METAL FRAME

Suggested Installation

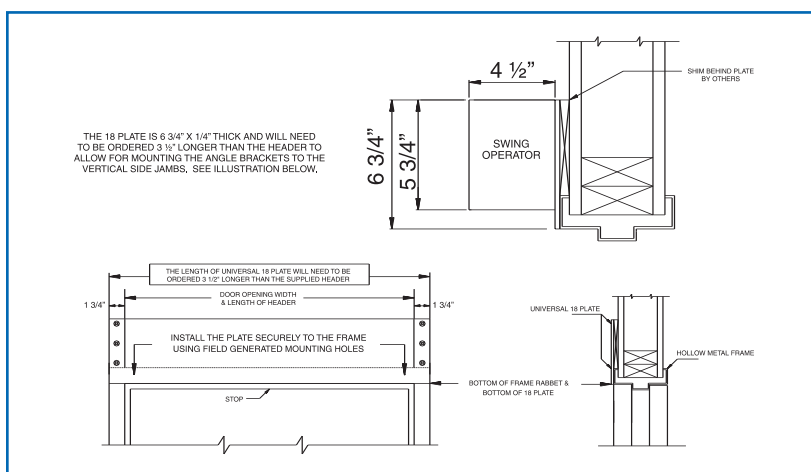

### MAXIMUM OPENING

Template allows 90 degree power opening and 90 degree manual opening.

#### Special Templates

Customized installation templates or products may be available to solve unusual applications. Contact LCN for assistance.

- ▶ **Butt Hinges** should not exceed 5" (127 mm) in width.
- ▶ **Reveal** for push installations should not exceed 10" (254 mm) for REGULAR ARM and 20" (508 mm) for LONG ARM.
- ▶ **Head Frame** minimum 1 3/4" (44 mm). Face frame 6 3/4" (171 mm) total operator clearance.
- ▶ **Top Rail** minimum 2 3/4" (70 mm).
- ▶ **Opening & Closing Time** are variable by adjustments to the electronic control box. Maximum hold open time adjustable up to approximately 32 seconds.
- ▶ **System Diagram** see "AUTOMATIC OPERATORS" section pages 54-55 for typical system wiring and page 58 for electrical data.
- ▶ Please consult your local SSC representative or LCN for assistance with specific installations and material requirements.

## MOTOR GEARBOX

### MOTOR GEARBOX (STANDARD FORCE) – SENIOR SWING, 9540-3454

Driving mechanism for operator. Provides 15lbs opening force. Handed.

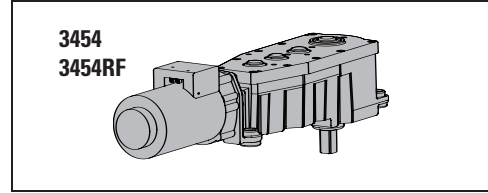

### MOTOR GEARBOX (REDUCED FORCE) – SENIOR SWING, 9540-3454RF

Driving mechanism for operator. Provides 11lbs opening force. Handed.

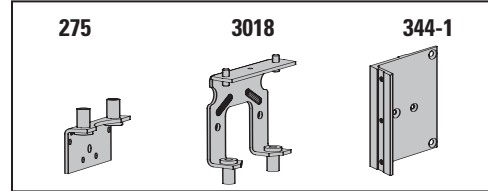

## MOUNTING BRACKET

### MOUNTING BRACKET – 2 3/4", 9540-275

Motor gearbox mounting bracket for 2 3/4" offset pivot or butt hinge installations. Front bracket.

### REAR MOUNT BRACKET, 9540-3018

Motor gearbox mounting bracket. Rear bracket.

### ANGLED BRACKET, 9540-334-1

Mounting bracket for surface applications.

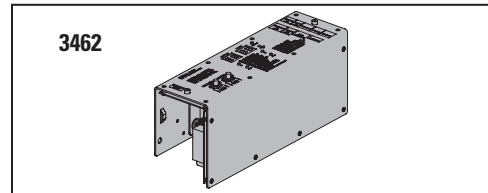

## CONTROL BOXES

### CONTROL BOX – SENIOR SWING, 9540-3462

Electronic controlling device for Senior Swing.

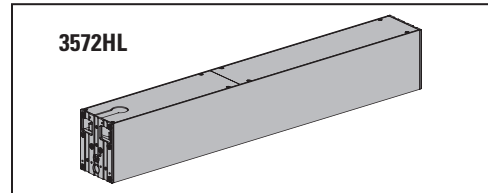

## HEADERS

### Header, 9540-3572HL

Standard, mounting header. Single door, single operator. Specify length 30" to 49" maximum.

### Header, 9540-3572DD

Standard, mounting header. Double door, single operator. Specify length 49" to 98" maximum.

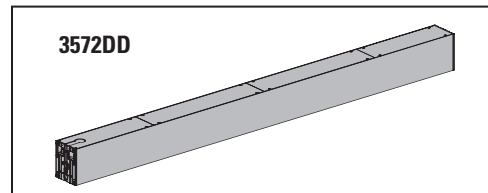

## END CAPS

### HEADER END CAPS, 9540-334

End cap with openings for wiring.

### END DRESS PLATE, 9540-334-2

Metal finish end cap.

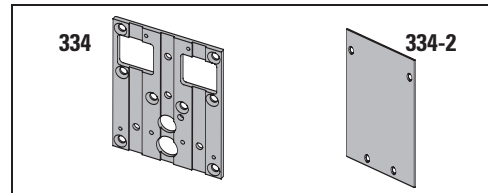

# LCN 9540 SERIES

## ACCESSORIES

### ARMS

#### REGULAR ARM ASSEMBLY, 9540-3077

Handed arm.

#### REGULAR LONG ARM ASSEMBLY, 9540-3077L

Handed arm.

#### MAIN ARM, 9540 -77

Handed arm attaches to motor gearbox.

#### LINKAGE ASSEMBLY – 15", 9540-79

Threaded rod attaches to door. Extends from main arm.

#### LINKAGE ASSEMBLY – 32", 9540-79LR

Threaded long rod attaches to door. Extends from main arm. Used for reveal 10" to 20".

### INSTALLATION ACCESSORIES

#### SPINDLE PLATE – 2 3/4", 9540-11A

Hides bottom of motor gearbox. Completes header box. Cutout allows for motor gearbox shaft. For 2 3/4" offset pivot or butt hinge installations.

#### FILLER PLATE BLANK, 9540-12

Completes length of header box. (Specify Length)

#### MOUNTING PLATE, 9540-18

Optional mounting plate for standard hollow metal door frames. Specify length 33" to 98" maximum.

NOTE: The length of a universal 18 plate will need to be ordered 3 1/2" longer than the supplied header.

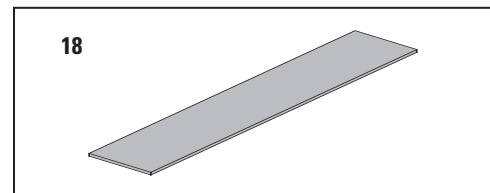
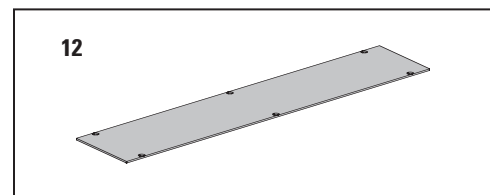
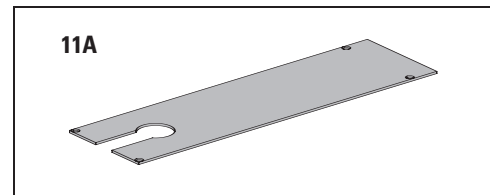
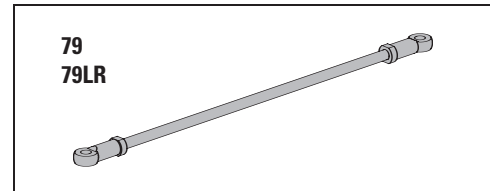
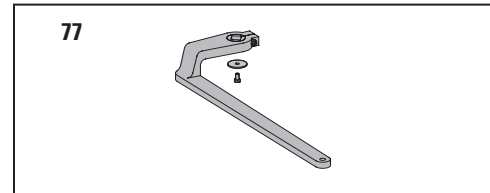
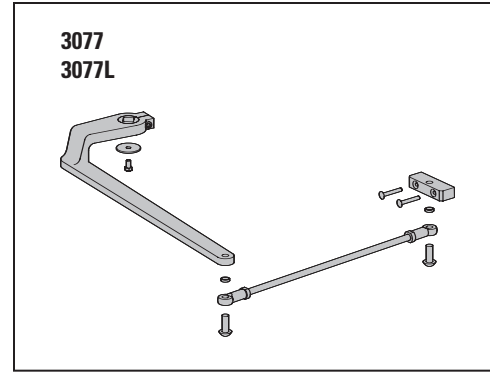

## TABLE OF SIZES

→ Indicates recommended range of door width for operator.  
 Note: For all Senior Swing Series  
 Single Door - Width per leaf 36" minimum, 48" maximum

### DOOR WIDTH

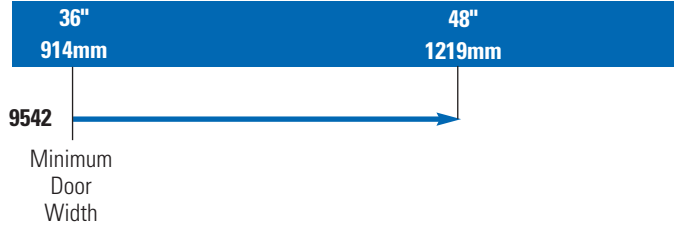

## HOW-TO-ORDER 9540 SERIES OPERATORS

### 1. SPECIFY HAND

- RH
- LH

### 2. SPECIFY FINISH.

- Standard Anodized Finish \_\_\_\_\_  
 Aluminum or Dark Bronze

#### **Operator will be shipped with:**

- STANDARD MOTOR GEARBOX (SF)
  - STANDARD CONTROL BOX (SC)
  - 36" HEADER (36HL)
  - REGULAR ARM (3077)
  - 2 3/4" PIVOT POINT
  - WOOD and MACHINE SCREW PACK
- Unless options listed below are selected.*

## OPERATOR OPTIONS

### MOTOR GEARBOX

- Reduced Force Motor Gearbox (RF)

### HEADER

- HL \_\_\_ (Specify length 36" to 49")
- DD \_\_\_ (Specify length 49" to 98")

### MOUNTING PLATE

- Plate, \_\_\_\_\_ (Specify Length 30" to 98")

### ARM

- Long Arm (3077L)

### FINISH

- Custom Anodized Finish \_\_\_\_\_
- Custom Painted Finish \_\_\_\_\_

### SPECIAL TEMPLATE

- ST- \_\_\_\_\_